

APPROVED	2/28/21	1921
CITY ENGINEER	JOHN S. LINDLEY	
REGISTERED CIVIL ENGINEER NO.	4771	
DRAWN BY	W. J. SHERS	
CHECKED BY	W. J. SHERS	
REGISTERED CIVIL ENGINEER NO.	2766	
SHEET	17	OF
RECOMMENDED	6/2/21	
BY	W. J. SHERS	

SIGNAL RELOCATION SHEET 1
 DEPARTMENT OF ENGINEERING
 CITY OF SAN BERNARDINO
 BASE LINE STREET
 Between H Street and Wilkerson Avenue
 Wicksburg

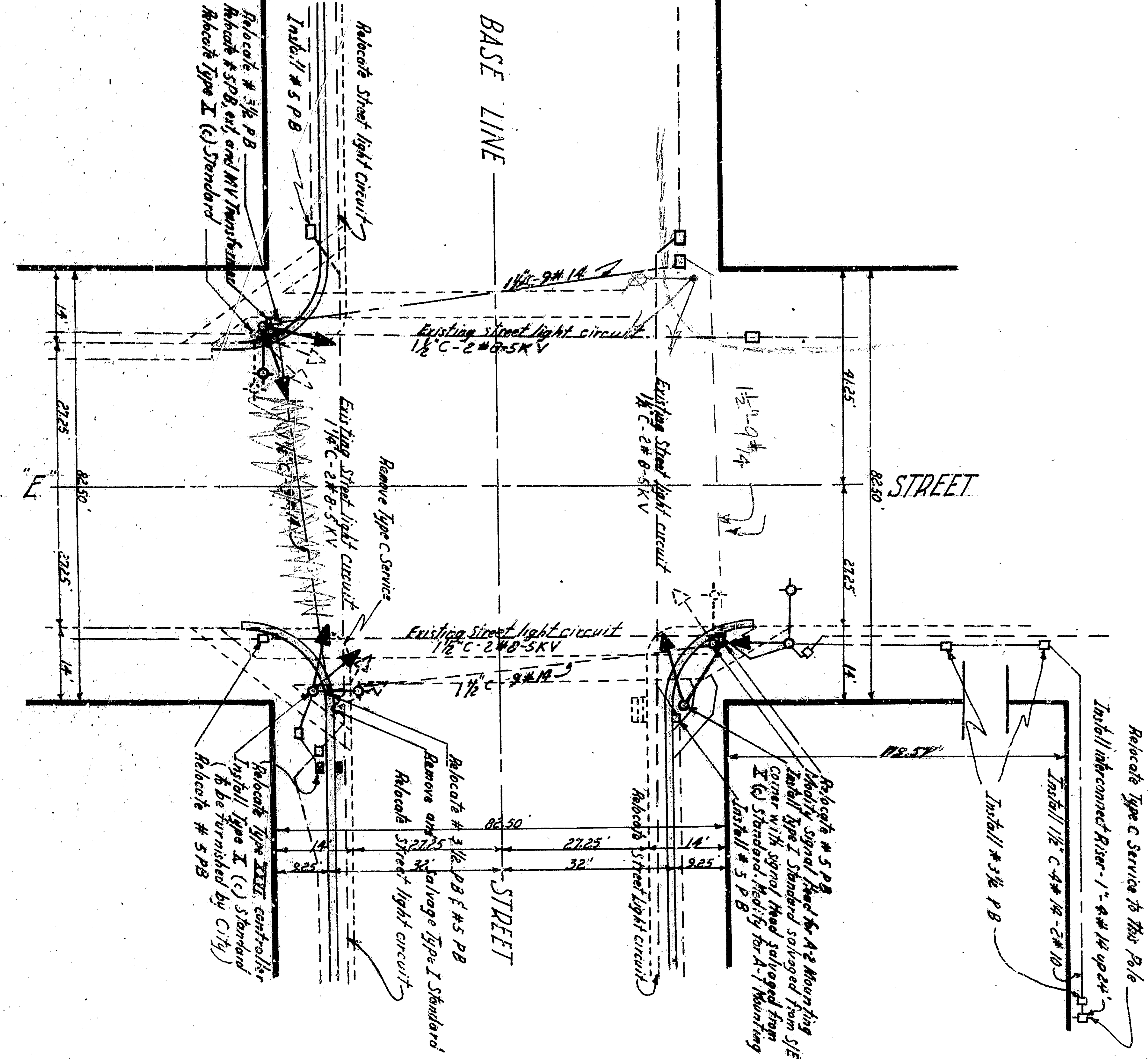
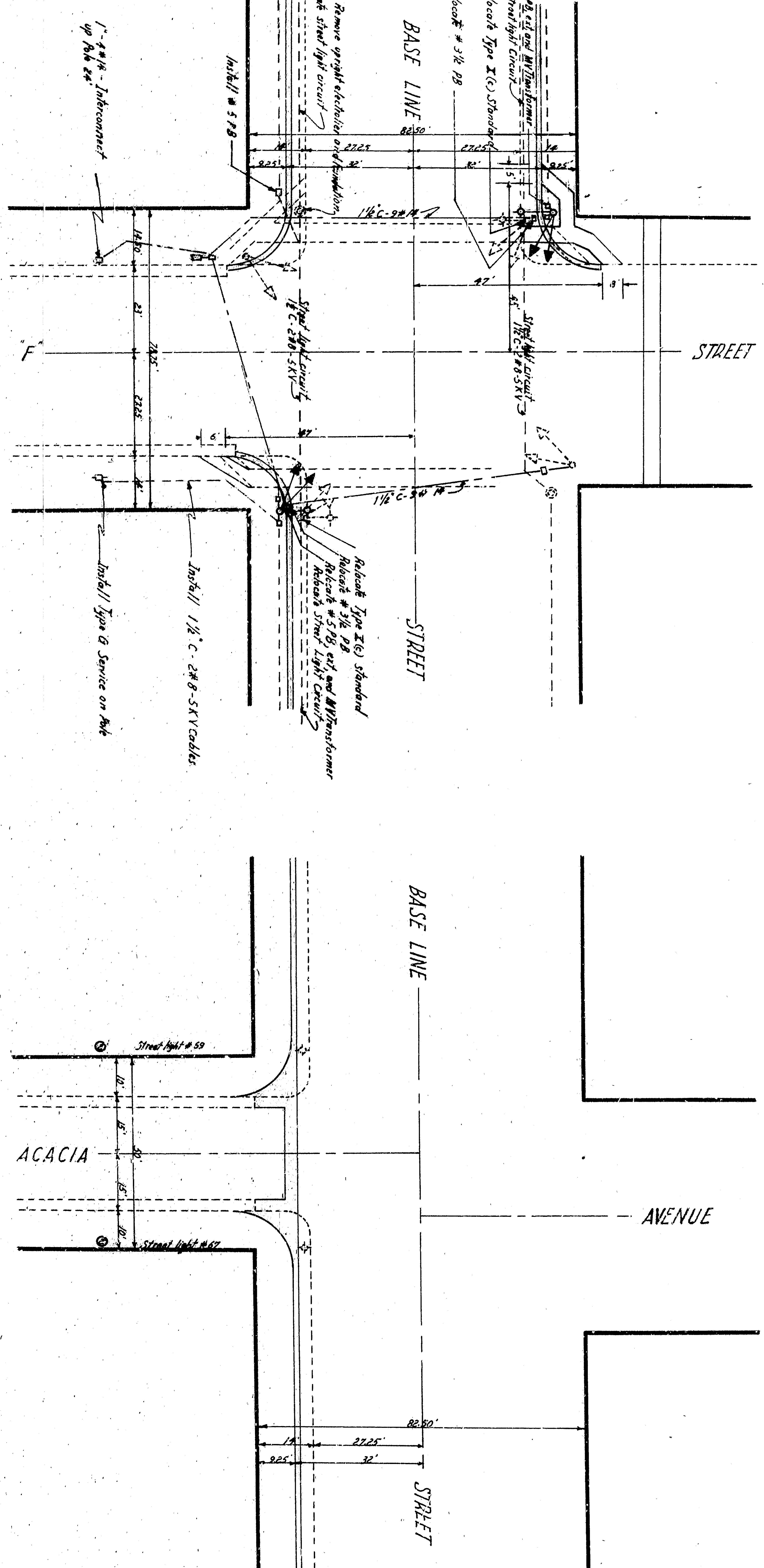


APPROVED	2007-07-27	1924
CITY ENGINEER	DAVID L. WILSON	
REGISTERED CIVIL ENGINEER NO.	4711	
DRAWN BY	W. J. WILSON	
CHECKED BY	W. J. WILSON	
REGISTERED CIVIL ENGINEER NO.	2766	
SHEET	17	OF RECOMMENDED 26
DATE	5/2/07	

SIGNAL RELOCATION SHEET 1
 DEPARTMENT OF ENGINEERING
 CITY OF SAN BERNARDINO
 BASE LINE STREET
 Between H Street and Wilkerson Avenue
 WILKINSON

1161288




AMERICAN NATL BANK BUILDING

APPROVED	2/28/21	1921
CITY ENGINEER	W. L. ...	
REGISTERED CIVIL ENGINEER NO. 4711		
DRAWN BY	...	
CHECKED BY	...	
REGISTERED CIVIL ENGINEER NO. 2766		
SHEET 17 OF 18	RECOMMENDED	6/2/21
BY SHEETS		

SIGNAL RELOCATION SHEET 1
 DEPARTMENT OF ENGINEERING
 CITY OF SAN BERNARDINO
 BASE LINE STREET
 Between H Street and Wilkerson Avenue
 Wilkerson